

MECHANICAL DETACHABLE GOOSENECK TRAILER



Commercial

Mechanical Detachable Gooseneck Trailer



Commercial

MECHANICAL DETACHABLE GOOSENECK TRAILER



Mechanical Detachable Gooseneck Trailer... Strong, Lightweight, Corrosion Resistant



Removable Gooseneck Rollers

The gooseneck roller pin is removable rather than welded in, making maintenance and replacement easier.



Aluminum Upper Deck

The aluminum outer rail and cross members of the upper deck are not only aesthetically pleasing, but they're strong, lightweight, and offer improved corrosion resistance.



Optional Aluminum I-Beam Cross Members

Large aluminum I-beam cross members in the main deck offer optimum corrosion resistance and load-bearing strength.



Sealed Electrical System

Rubber-mounted LED lights are standard and rubber grommets protect the wiring wherever it runs through the frame. (Shown here with optional stainless security rings.)



Mini-Boom Trough

The mini-boom trough is deeper and longer to better accommodate the hitches on agricultural equipment, as well as many types of construction equipment.



Adjustable Ride Height

Adjustable ride height control is standard, with the controls conveniently located near the rear tail channel.

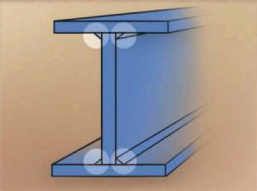
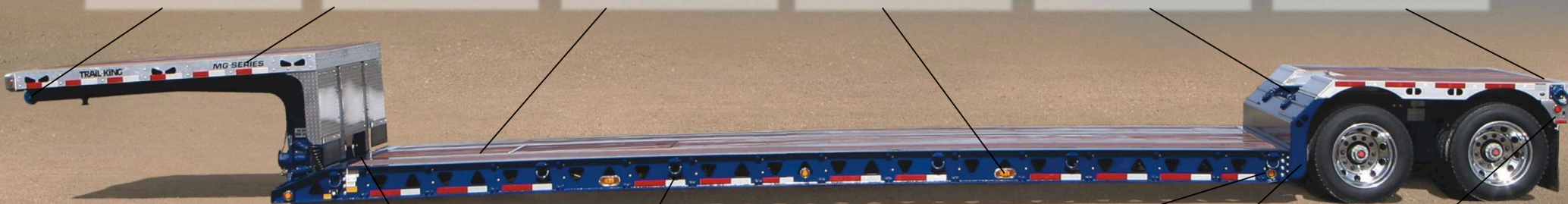

One-Piece Construction

Trail King I-beams are constructed of one-piece web and flange material and welded on all four sides to seal and protect seams from rust. The entire trailer is primed and painted with a two-component polyurethane primer and paint before decking and air, hydraulic, and electrical lines are installed, for complete protection from the elements – even in places you can't see.



Air-Operated Lock Pin

The air-activated, positive self-locking pin on the gooseneck can be conveniently operated from the side of the trailer.



D-Rings And Outrigger Brackets

Bent-style heavy duty D-rings and outrigger brackets are standard equipment.



Huck Bolted Wheel Area

The deck and the wheel area are painted before assembly, and then huck bolted together for maximum corrosion resistance, even in places you cannot see.



Improved Corrosion Resistance

Moisture-trapping areas have been designed out of the structure of the trailer, so the chance for corrosion is significantly reduced.



Brackets

Wide Load sign, flag holder, and strobe light brackets are standard equipment.



Mechanical Detachable Gooseneck Trailer

STANDARD EQUIPMENT

	TK60MG 60,000 lbs.	TK75MG 75,000 lbs.	TK90MG 90,000 lbs.
Concentrated capacity in 16'			
14" kingpin setting / 49" loaded 5th wheel height	x	x	x
10' 0" (14" KP) detachable gooseneck	x	x	x
Gooseneck reinforced for flip		Optional	x
Air-activated, positive self-locking pin on gooseneck	x	x	x
12 bent-style D-rings on deck	x	x	x
2 straight on outer corners of wheel area			
2 straight on transition flange			
4-beam main frame construction	x	x	x
18" deck height	x	x	x
102" wide	x	x	x
29' 2" deck length	x	x	x
Tapered front approach with traction bars	x	x	x
Swing out brackets and storage area	x	x	x
Steel cross members in main frame			
8" I-beams alternating with 4" I-beam for 12" spacing	x	x	x
1 3/8" apitong decking	Raised	Raised	Flush
Triangle cut-outs on deck beams	x	x	x
Aluminum steel combo gooseneck	x	x	x
Aluminum steel combo wheel area	x	x	x
Reinforced for 3 axles			
Mud flaps	x	x	x
Flag holders, front of gooseneck and rear of trailer	x	x	x
Wide load sign brackets	x	x	x
Rubber mounted sealed lights and harness system	x	x	x
LED Light package (50-state legal)	x	x	x
1 pair on gooseneck			
5 pair on main deck X-O-X-O-X			
1 pair on wheel area			
Electrical system per DOT regulations	x	x	x
Air and electrical installed after paint	x	x	x
7-pole electrical connector	x	x	x
Air ride suspension w/adjustable ride height	x	x	x
Raising and lowering for air ride	x	x	x
Liquid-filled air gauge	x	x	x
25,000 lb. (5/8" wall) axles	x	x	x
16 1/2" x 7" air brakes	x	x	x
4S2M anti-lock brakes	x	x	x
8.25 x 22.5 10-hole disc wheel	x	x	x
255/75R22.5 16-ply tires	x	x	x
Automatic slack adjusters	x	x	x
One-piece oil seals	x	x	x
Red & white conspicuity markings	x	x	x
Blasted prior to paint	x	x	x
Color: Trail King 2-part polyurethane	x	x	x

All specifications are subject to change without notice. Trailers pictured in this brochure may feature optional equipment.

Distributed by:



Contract
GS-30F-0004X



OPTIONAL EQUIPMENT



Adjustable Gooseneck

A notched, 5-position control bar allows you to quickly and easily change the 5th-wheel height of the gooseneck between 3" up to 3" down from standard ride height.

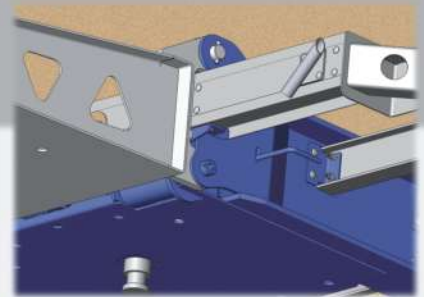

Retractable Gooseneck Pins

Retractable gooseneck pins make it possible to switch to using a flip gooseneck without having to remove the rollers.



Aluminum Pull-Outs

Aluminum pull-outs can be pulled out from box beam cross members to provide an overall width of 13 feet.

TRAIL KING Industries

MECHANICAL DETACHABLE GOOSENECK TRAILER

P.O. Box 7064 ■ Mitchell, SD 57301 ■ 800-843-3324 U.S. & Canada ■ 605-996-6482 ■ Fax: 605-996-4727 ■ www.trailking.com

All rights reserved Trail King Industries, Inc. FORMTKMG3/2012-2.5